

S-5!®

The Right Way!

The right way to attach almost anything to metal roofs!

Installation Instructions

S-5!® Warning! Please use these products responsibly! Visit our website or contact your S-5! distributor for available load test results. The user and/or installer of these parts is responsible for all necessary engineering and design to ensure the VersaGard™ has been properly spaced and configured.

Notice to S-5! users: Due to the many variables involved with specific panel products, climates, snow melt phenomena, and job particulars, the manufacturer cannot and does not express any opinions as to the suitability of any S-5! assembly for any specific application and assumes no liability with respect thereto. S-5! products are tested for ultimate holding strength on various profile types and materials. This information is available from the S-5! website: www.S-5.com. This document is an installation guide only and the photographs and drawings herein are for the purpose of illustrating installation tools and techniques, not system designs.

The VersaGard™ is made for trapezoidal, exposed-fastened profiles.

Tools Needed

- Electric Screw Gun
- Rag
- String Line
- Tape Measure

VersaGard should be placed in the flat of the panel, between the ribs, and never straddling a striation. VersaGard must be mounted directly over and into the supporting structure of the roof, i.e. wood decking, wood or steel purlins, or trusses, NEVER into the metal roofing material alone.

To accommodate various rib heights and to support one- or two-pipe preferences, VersaGard comes with two 1.05" holes (1" pipe not included). To support PV installation, the diagonal "slot" provides height flexibility.

To Install VersaGard™

1. Determine the location of the supporting structure of the roof. VersaGard can be installed parallel (for snow retention or PV installations) or perpendicular to the rib (for PV installations). When possible, secure VersaGard using all hole locations; when not possible, always use the two upslope hole locations. The only surface preparation necessary is to simply wipe away excess oil and debris.
2. Peel the release paper from the base, align, and apply to roof surface.
3. Secure the VersaGard by drilling screws into the pre-punched holes directly into the supporting structure of the roof. Consult the S-5! Load Table at www.S-5.com/LoadTable for more information. To ensure they are installed in a straight line, install a single VersaGard on each end of the roof at a measured, consistent distance from the bottom edge of the roof. Use a string line between the two VersaGards. Mount the remaining VersaGards along the string line, directly into the supporting structure of the roof.

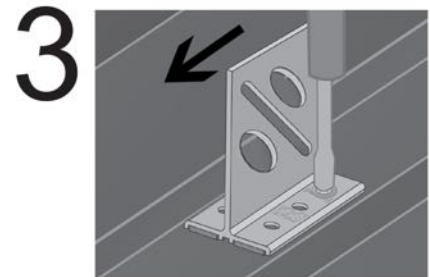
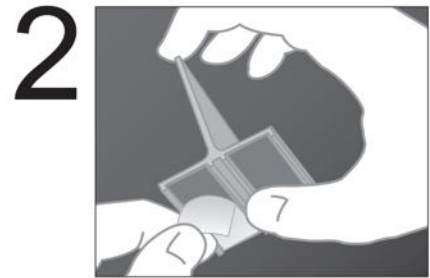
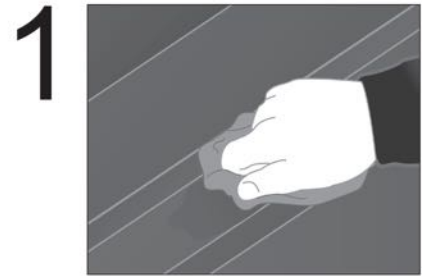

ALL...THE BEST Inc.

www.atbest.ca

Construction Sales & Marketing

S-5!® Warning! Please use this product responsibly!

Products are protected by multiple U.S. and foreign patents. For published data regarding holding strength, fastener torque, patents, and trademarks, visit the S-5! website at www.S-5.com. Copyright 2014, Metal Roof Innovations, Ltd. S-5! products are patent protected. S-5! aggressively protects its patents, trademarks, and copyrights. Version 012015.

These instructions are for use by those experienced in the trade. Always follow appropriate safety precautions and use appropriate tools.